



Before using your washing machine, please read this manual carefully and keep it for future reference.

Washing Machine

USER'S MANUAL

MT700W

Read This Manual

This manual contains information on proper installation, usage and maintenance of your washing machine. A little preventive care on your part can help prolong the life and usage the appliance. Answers to common problems are listed in the Troubleshooting Tips section of this manual.

Contents

Safety and precautions.....	2
Installation of the washer.....	5
Preparation before washing.....	7
Parts identification of the washer.....	8
Instruction of the washer operation panel.....	9
Quick start.....	11
The main wash.....	12
Special features.....	13
About the procedure of full automatic wash program.....	15
Cleaning and Maintenance of the washing machine.....	16
Identify usual trouble of washer.....	17
Malfunction display and solutions.....	18
Technical specifications.....	18

Observe the following items in order to prevent from injuring yourself, others and the damage of property:



Warning

This indicates serious injury or death to human being may be caused.



Caution

This will remind you that injury to people and damage to property may occur.

Please observe following contents of graphics.



This graphics represents [cause attention] ,and detailed cautions will be displayed inside the graphics.



This graphics represents [operation prohibited], and detailed prohibitive items will be displayed inside the graphics.



This graphic represents [forcible execution], and detailed forcible execution items will be displayed inside the graphics.



Warning

Please do not disassembly and assembly the machine without authorization.



No dismantling



Please do not insert your hand and take out clothes inside the spin barrel before it is fully stopped.



No touching



Please do not install the machine in damp and raining environment to avoid electric shocking, catching fire, faults and distortion accidents.



No dampness



Please do not directly rinse the machine with water when cleaning.



No rinsing



 **Warning**

Please do not let children climb the machine or peer into the rotating spin barrel to avoid accidents.



Prohibited

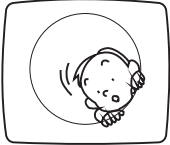

It is prohibited to wash the clothes touching with kerosene, gasoline, alcohol and other flammable materials.



Prohibited



Please do not damage power flexible cord and power plug to avoid electric shocking, short circuit and catching fire.



Prohibited

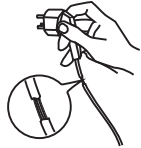

Regularly clean the power plug to remove dust and dirt to avoid contact failure.



Please pull out plug from the socket if the machine is not in use.



Pull out the plug

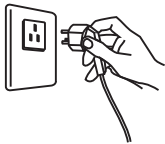

Please well connect the earth line of socket to avoid electric shocking by accidental leakage.

(earthing)



Earthing

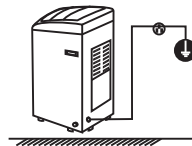

Please insert the power plug tightly.

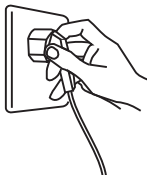

Please do not place on the washer burning candle, mosquito-repellent incense, cigarette and other flammable things, as well as electric stove, air heating fan and other heating sources.



Smoke and fire prohibited



Please use correct power source.



Please do not pull out or insert the plug with wet hands to avoid electric shocking.



Wet hands are prohibited

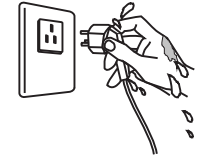

 **Caution**

Please ensure that the water inlet pipe is connected and the tap is opened before washing clothes.

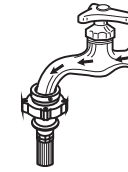

The water temperature shall not exceed 50°C when washing with warm water.



Prohibited



Customers are not allowed to change the power line without permission.



Prohibited



It is strictly prohibited to place and sit children or lay weights on the washer.



Prohibited

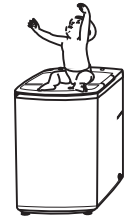

Please do not pull the electric cord when pulling out the plug.



Please do not wash down jacket, raincoat, fishing coat and similar clothes in the washer.



Prohibited



Installation of the washer

Remove package

- Remove package and take out the bottom board of the cabinet on the foam cover.
- Open the lid of washer's door and take out accessories.
- A trial operation or washing on the foamed cushion is strictly forbidden.

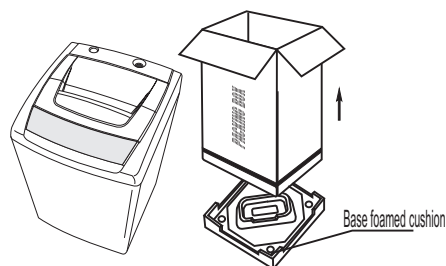

Installation of drain hose

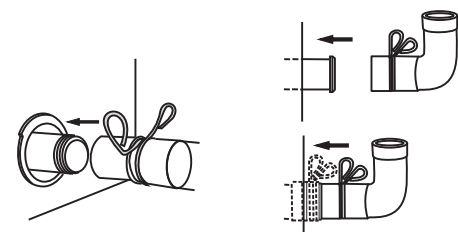

Note: Use only the new supplied water hose with your new appliance do not use a hose from your existing machine or a hose that has been used previously.

- Completely seat the drain hose over the drain connector. Installation of water inlet hose.
- Fix and tighten it with a hoop. (As shown in the figure, and you can use a pliers to finish it.)

Installation of water inlet hose

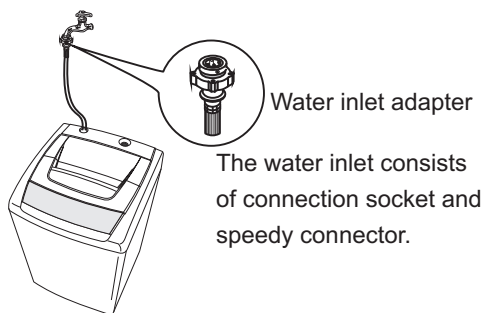

The water inlet consists of connection socket and speedy connector.

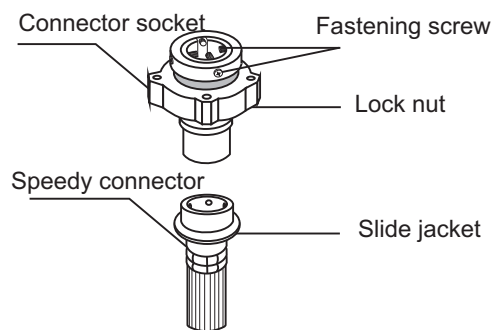

Installation of the washer

Installation of water inlet pipe

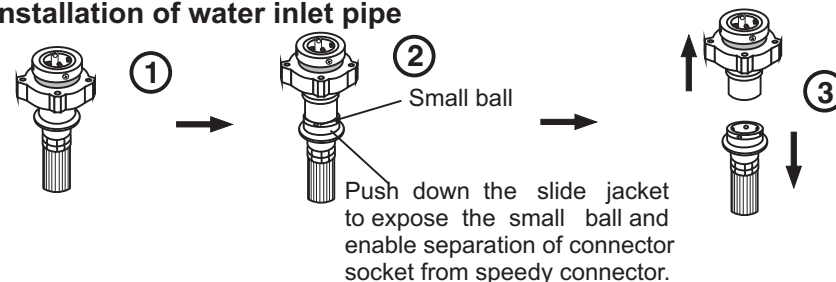

Push down the slide jacket to expose the small ball and enable separation of connector socket from speedy connector.

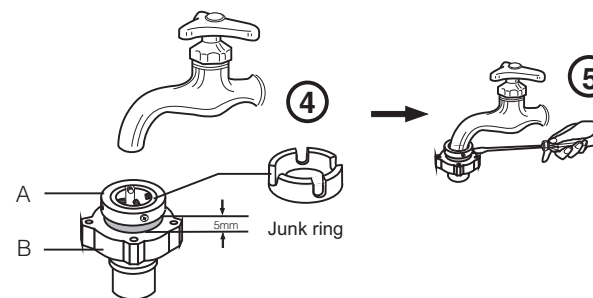

Unscrew four screws of part A and sleeve part A horizontally over the mouth at the end of water tap (the mouth at the end of water tap must be flat and smooth. Flatten it by filing if it is not flat) and push it upward with force making the rubber washer firmly press the plane center of water tap mouth. Then tighten the screw sequentially. After that, tightly screw on part B.

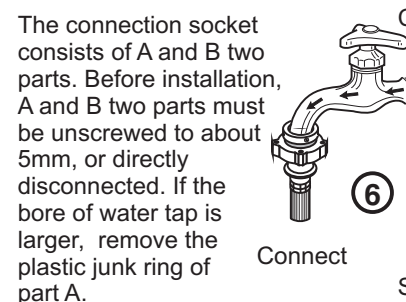

The connection socket consists of A and B two parts. Before installation, A and B two parts must be unscrewed to about 5mm, or directly disconnected. If the bore of water tap is larger, remove the plastic junk ring of part A.

Connect: Push down the slide jacket of speedy connector (4 small balls must be exposed), insert it into the connection socket and then push upward. Release the connection of water tap with speedy connector is completed. If it is required to feed water, simply open the water tap. Separate: Close the water tap, push down the slide jacket of speedy connector and pull out the speedy connector.

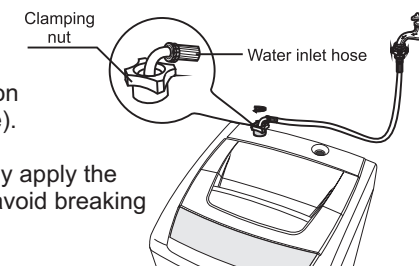
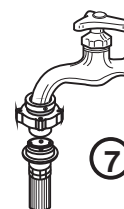

Tightly screw another end of water inlet hose on water inlet valve . (with rubber seal ring inside).

Note: When tightening the clamping nut, evenly apply the force and do not twist the water inlet valve to avoid breaking of water inlet valve joint.

Preparation before washing

1 Adjust the adjustable foot making the washer be placed stable.

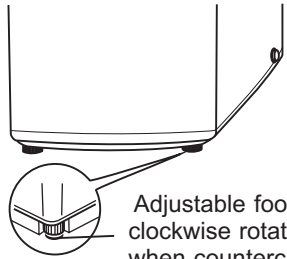

Adjustable foot (extend when clockwise rotating and shorten when counterclockwise rotating)

(Slightly incline the washer first and loosen the adjustable foot knob. Adjust the adjustable foot so as to ensure four corners of washer be steadily contacted with the ground. Then tighten the adjustable foot knob and lock it. If the ground is obviously not flat, correction should be made on the ground surface, otherwise the washer barrel will incline and knock the cabinet)

2 Install the water inlet hose.

one inlet hose

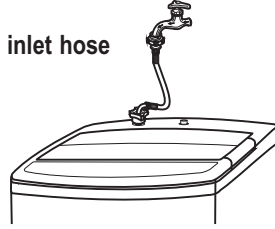

two inlet hoses

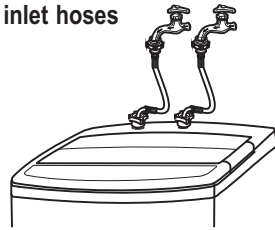

3 Connect with power source.



5 Put down the drain house.

Gravity drain

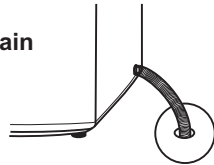

Upper drain

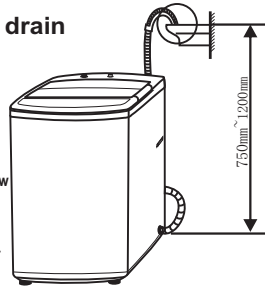

Note:
The water will overflow when the height of the drain hose under 750mm.

6 Put in clothes and suitable amount of washing powder.

NOTICE



Before washing, please do take out coins, keys and other hard goods, and pull to close the zip fastener to prevent clothes and barrel from damage.



Parts identification of the washer

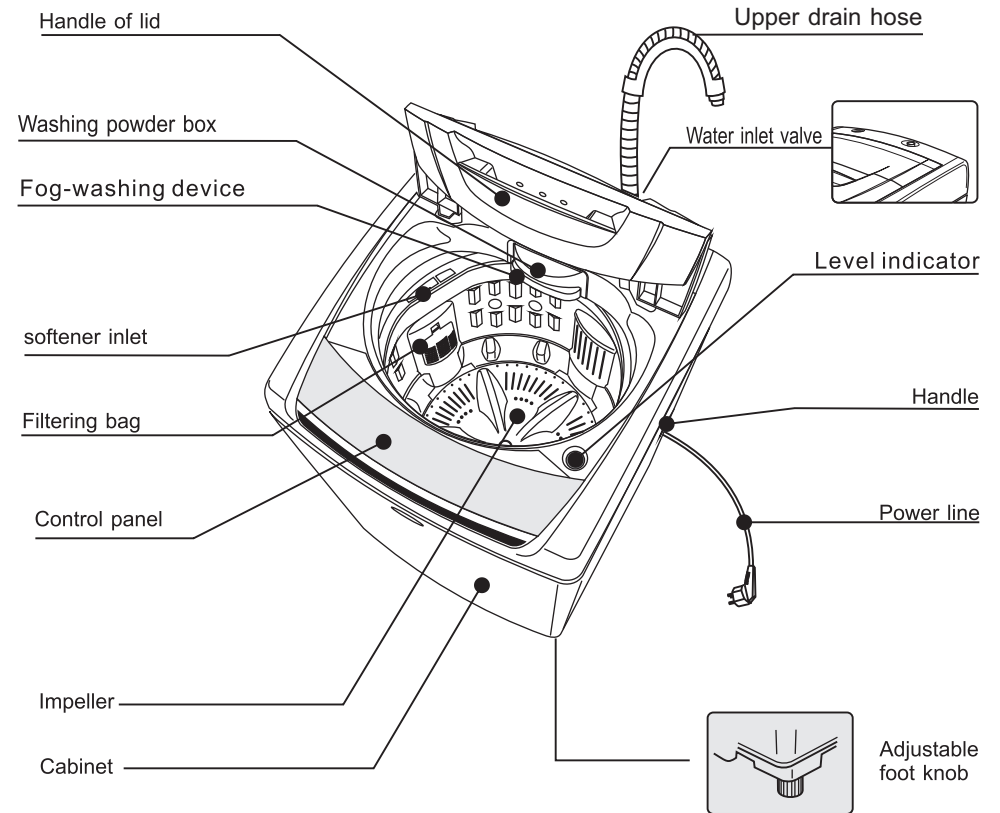

Accessories



Inlet hose

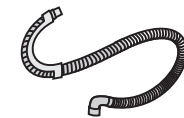

Upper drain hose

Instruction of the washer operation panel

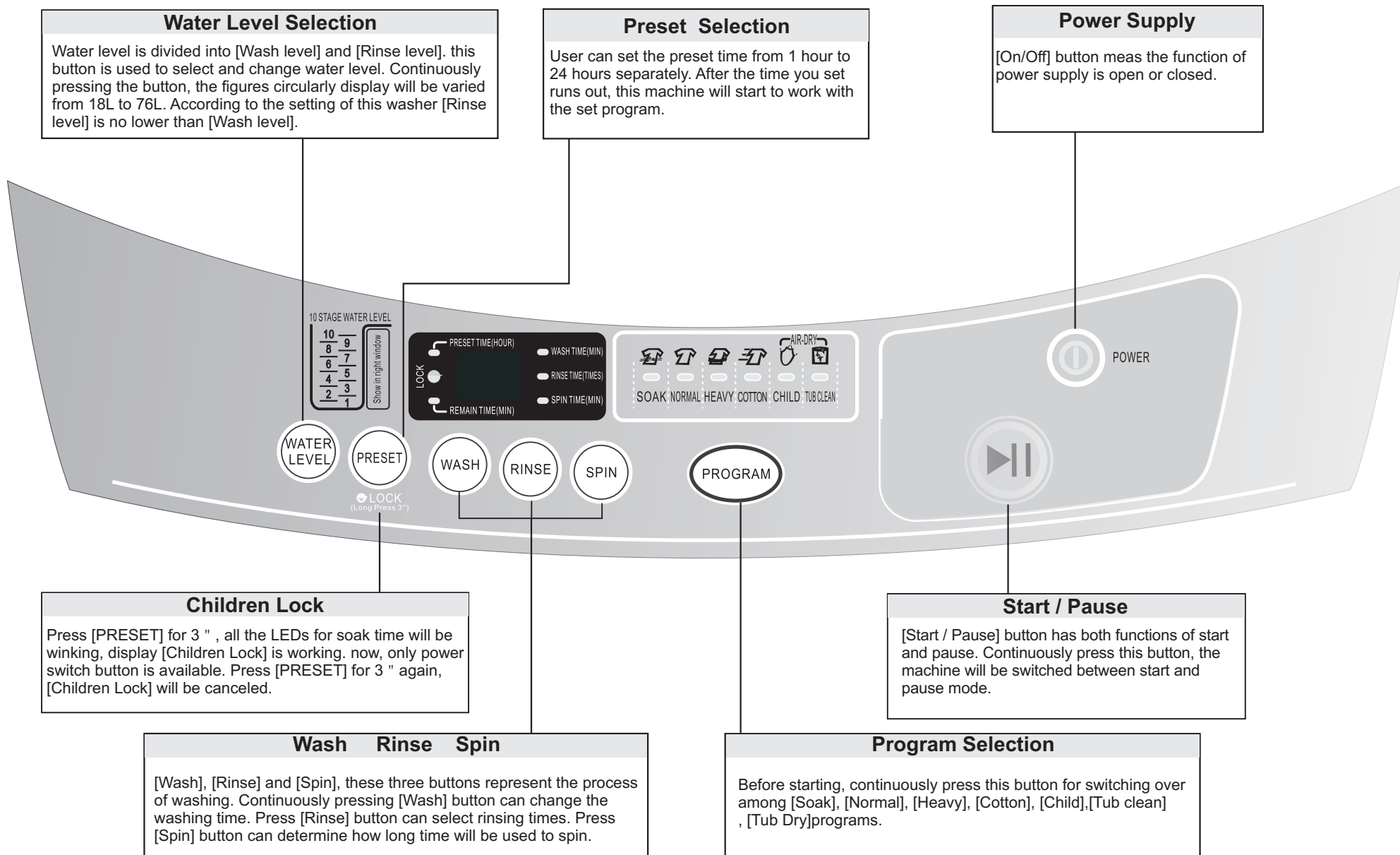

Quick start

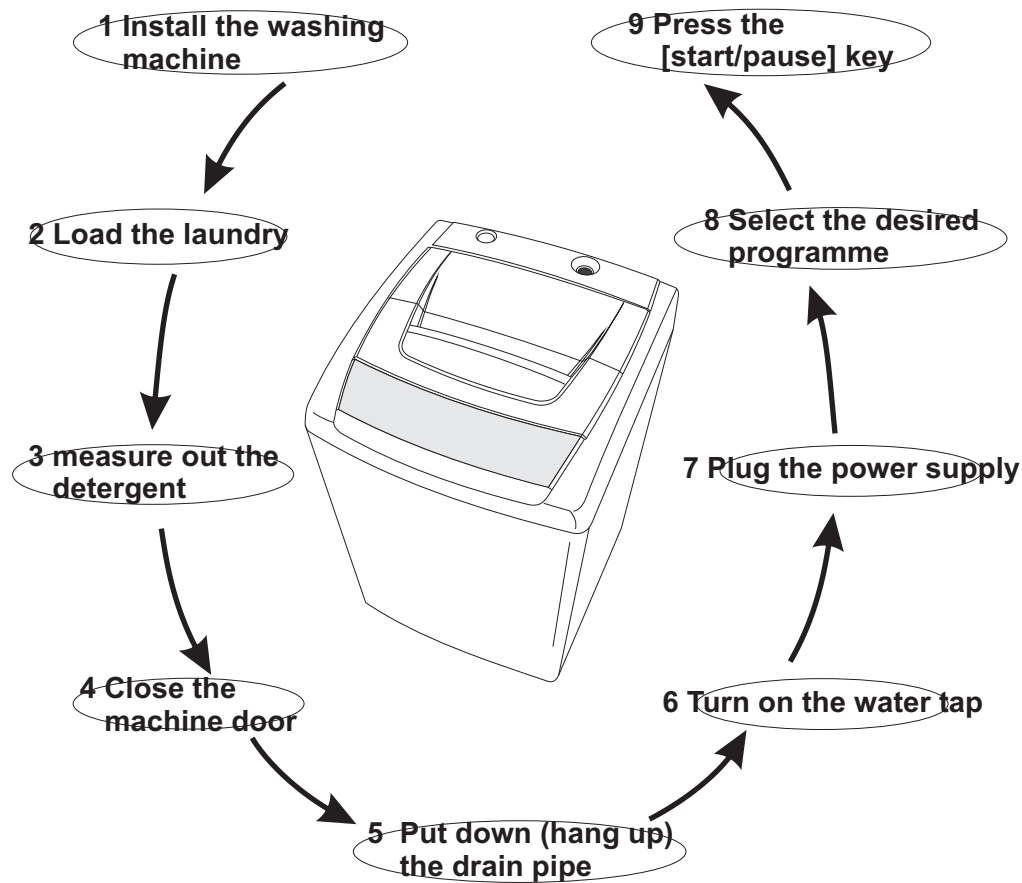

Programme selection

- 1 Press the POWER button.
- 2 Select the proper water level or other attached functions.
- 3 To press the start/pause key.

The wash stops

- When the wash stops, the buzzer will buzz continuously for 6 times and then the power will be automatically cut off.
- Turn off the water tap.
- Although the power can be cut off automatically, the power plug must be pulled out as well for the safety.

The main wash

Instruction to the NORMAL program

- [Normal] wash program is the easiest, most convenient and most common washing program. When the user presses the power switch and then presses [Start/Pause] button, the normal washing program will start to work.
- When the washer starts to work, the digital tube shows the remaining time. The indicator light which stands for remaining time is flickering.

Steps in details

1. Press the power switch.
2. According to the washing amount, choose the proper water level.
3. Press START/PAUSE button.

Instruction to single wash procedure

- User may freely select any single procedure, or any combination of procedures among WASH, RINSE and SPIN according to the actual requirements. It is only required to turn off any one or two of these three indicators that is not needed by the user. And keep the indicator showing the process selected by the user.
- Single wash -- after switching on the power, turn off RINSE and SPIN two indicators by pressing these two keys. The operation for single rinse and single spin is similar.
- Single wash-spin -- after switching on the power, turn off RINSE indicator by pressing that key. The operation for single rinse-spin and single wash-rinse is similar.

Instruction to self-programmed procedure

- User can freely select any combination among WASH, RINSE and SPIN modes according to the dirty degree of clothes.
- Detail operation methods as follows:
- Continuously pressing the washing button to select washing time.
(1~20 minutes, or no wash process)
 - Continuously pressing the rinse button to select rinse times.
(1~3 times, or no rinse process)
 - Continuously pressing the spin button to select the spin time.
(3~9 minutes or no spin process)



- Close the lid of the door when the machine is running, otherwise, it will automatically stop working during the spin process and send out an abnormal warning.
- The washer will not work when the filled water does not reach the set water level.
- The selection of rinse water level: the level is equal to wash water level. Press [Rinse Level] button, the indicator light which stands for rinse level flickers. User can select the rinse water level according to needs. Rinse level exceeds that wash level all the time. It shows the wash level if not pressed this button. And only shows the rinse level when rinsing.
- After pressing down [Power Switch], if the [Start / Pause] button is not pressed, the power will be automatically cut off after 10 minutes.

Special features

SOAK

- SOAK program is used for washing dirtier clothes. This program can be used in conjunction with other programs except TUB CLEAN.
- When you press the SOAK button, the indicator light of soak lightened. And continuously press the SOAK button to choose the soak time (10minutes, 20minutes or 30 minutes).

HEAVY

- HEAVY program is used for washing the clothes that is not so dirty and the whole washing process will be completed in about 25 minutes.

COTTON

- COTTON program is suit to wash the shirts and cotton or wool clothes.

CHILD

- CHILD program is used for washing the children clothes that is not so dirty and the whole washing process will be completed in about 25 minutes.

TUB CLEAN

TUB CLEAN program be adhere to wash powder's residue inside and outside the barrel because of the pollution and the problem of the water quality. It will take smelly and the drain will not be flowing. Otherwise, the adhering residue will take off during the wash process. And the clothing will be dirty. User should clean the tub monthly.

NOTICE



- ! Please do not start the program continuously.
- ! You should take few chloric bleacher to enhance the effect of tub clean.
- ! This program is used for clean the barrel and do not put the clothes in.

Special features

AIR DRY

- AIR DRY program is that the formation of the swing of the wind within the barrel through high-speed rotation, which can dry the clothes barrel, and user can select different stage you need.

PRESET

- This washer has the functions of delay start for 24 hours.
- After the DELAY program start to work, the digital tube show the delay start time. And the indicator light which stand for delay lightened. When the time arrive, the indicator light which stand for delay goes out. And the indicator light which stand for remain lightened. Showing the remain time.
- The DELAY time stand for washing clothes after [XX] hours.

USER PROGRAM

- User can freely select any combination among "Wash ", "Rinse" and "Spin" modes according to the dirty degree of clothes. Detail operation methods are following:
- Continuously pressing the washing button to select different washing time, such as 18 minutes, 12 minutes, 6 minutes or no washing process.
- Continuously pressing the rinse button to select different rinse times, such as 3 times, 2 times, 1 time or no rinsing process.
- Continuously pressing the spin button to select the different spin time, such as 7 minutes, 5 minutes, 3 minutes or no spin process.

About the procedure of full automatic wash program

Contents Program	Water Level (Stage)	Wash Time (minutes)	Spin Time (minutes)	Complete Time (minutes)	Rinsing Times	Washings (recommended)
Soak	10	12	2	72	5	Normal clothes or dirty clothes
Normal	10	12	2	42	5	Normal clothes or not so dirty clothes
Heavy	10	16	2	46	5	bulky clothes
Cotton	10	14	1	34	5	Normal clothes or not so dirty clothes
Child	9	16	3	52	7	Children clothes
Tub clean	10	10	1	58	2	Empty
Air dry	9	16	2	27	5	Empty

Cotton program is selected during testing for a normally soiled load at rated load capacity.

Note: The time required will also vary with water pressures of intake pipe, different clothes textures and different water drain conditions.

Cleaning and Maintenance of the washing machine

- NOTICE**
- Make sure to pull out the power plug before the cleaning and maintenance.
 - Please keep the washer with neat appearance and perform correct maintenance to prolong the service life of washer.



Cleaning of water inlet hose joint

Unscrew and remove the water inlet hose joint from the washer and clean the filtering screen of inlet valve with brush.

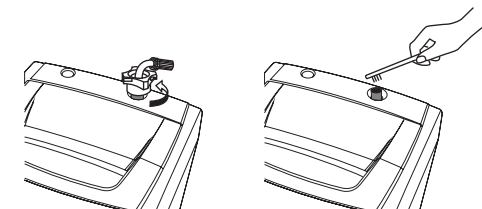

Cleaning of filtering bag

The special circulation water flow is designed for this washer, thus the flock powder and flock residues will be automatically collected into the filtering bag. After application, the user shall regularly clean the filtering bag to remove the flock powder and flock residues. Detail operation methods are following:

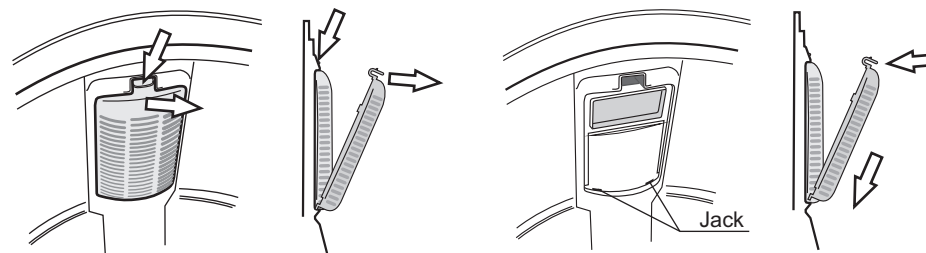

Press it according to the arrowhead point. And you can discharge the frame of filtering bag.

Put the frame of filtering bag into the two jacks and push into emphatically as shown in figure above.

Identify usual trouble of washer

When the washer is in trouble, please contact local service office or the sales service department of our company and the customer should not dismantle the machine without permission.

If the washer can not work normally, or appear abnormality or alarms, please check and correct as follows.

List of faults and inspection







Faults	Inspection Items
No water flows in	<ul style="list-style-type: none"> • If the power is off or the fuse is burned out. • If the water supply is cut off or the water pressure is too low. • If the inlet hose is properly connected and the water tap is opened. • If the filtering screen of inlet valve is blocked by dirt. • If the coil of inlet valve is damaged. (The slight electromagnetic sound is normal phenomenon when the inlet valve is switched on) • If the "Start / Pause" button is pressed after the power switch is pressed.
No washing	<ul style="list-style-type: none"> • If the power is off or the fuse is burned out. • If the power supply voltage is too low. • If the water amount reaches to the required water level. (The washer will not work if the water amount does not reach the required water level) • If it is set to "Delay" washing mode. (It will only start to work until the reservation time reached)
Abnormal draining	<ul style="list-style-type: none"> • If the water drain hose is placed very high. • If the end of water drain hose is sealed in pond. • If the internal rubber ring of drain valve is blocked by dirt.
Abnormal spin	<ul style="list-style-type: none"> • If the door lid is closed. • If all clothing piled largely at one side of barrel or the clothing is excessively placed. • If the washer is not placed in stable condition or it is placed in inclination state. (The ground is not flat). • If the motor belt is loosened.

Note: During the de spin process, if washing are piled at one side of the spin barrel, it will cause unbalance of spin barrel resulting in striking. At this moment, the computer inside the washer will feel this unbalance phenomenon and will automatically correct it (fill in water Washing). However, if unbalance situation is not removed after continuous three corrections, which means the computer auto-correction can not resolve the problem. Then the user has to manually and evenly place the clothing inside the barrel to solve the problem.

Malfunction display and solutions

When the washer is in trouble, please contact local service office or the sales service department of our company and the customer should not dismantle the machine without permission.

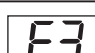
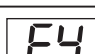
If the washer can not work normally, and the abnormal indication is shown in the nixie tube window or the machine alarms, please check and correct as follows.

Display	Causes	Methods
	Alarm for the power cut off failed.	1. Cut off power and start it 5 minutes later. 2. Report for repairing
	Alarm for reading EEPROM failed.	Report for repairing
	Alarm for abnormal water intaking.	1. Open the water tap. 2. Hydraulic pressure is low, increase inlet water amount.
	Alarm for water drain has not finished.	Check if water drain hose is placed correctly. Clean the stem.
	Alarm for lid not closed before spin.	Please close the door lid
	Alarm for washing stay at one side.	Placed the washing equably.
	Alarm for water level sensor.	Report for repairing
	High voltage protection $\geq 270 \pm 10V$	The power cut off automatically.

Technical specifications

Rated power supply	230V / 50Hz
Input power of motor	460W
Rated washing capacity	7.0kg
Rated spin capacity	7.0kg
Overall dimensions	550 X 565 X 924
Application water pressure	0.03MPa~0.8MPa
Weight of whole machine	38kg
Washing mode	New water flow
Draining mode	Upper drain
Spin mode	Centrifugal spin