

Connecting the Dishwasher

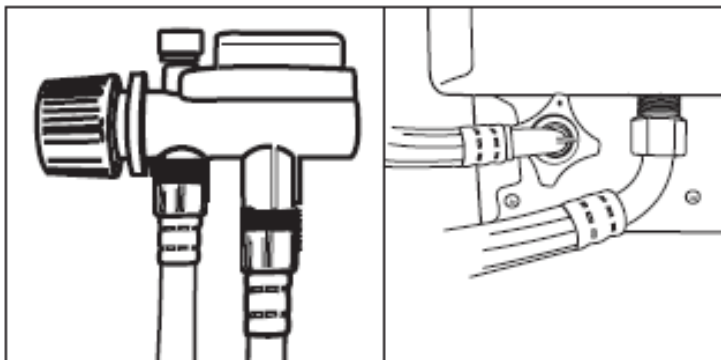

Your dishwasher comes equipped with a 'quick-connect' assembly (includes inlet and drain hose). The faucet adapter must be installed on the faucet before you can connect the dishwasher. This adapter is included inside your dishwasher.

The faucet adapter is compatible with faucets inclusive of either male (outside) or female (inside) threaded faucet connections.

- Screw the faucet adapter onto (or into) the faucet tap. Check for leaks (use Teflon or plumbers tape to eliminate any leaks if necessary).
- Connect the six-sided connection of the drain hose to the drain port connection on the back of the dishwasher cabinet. To avoid damage to threads, do not over-tighten.
- Connect the star-shaped connection of the inlet hose to the inlet port on the back of the dishwasher cabinet. Do not over-tighten.
- Connect the circular connection of the drain hose onto the longer (bottom) male connection on the quick connect.
- Connect the circular connection of the inlet hose onto the shorter (top) male connection on the quick connect.
- Attach the quick-connect assembly onto the faucet adapter, by pulling down the outer locking collar on the quick connect, while pushing the quick-connect assembly upward onto the faucet adapter.
- Release the locking collar when the quick-connect assembly snaps onto the faucet adapter. Verify the connection is secure.
- Slowly open the hot water line and check for any sign of water leakage at all hose connections. If leaks are located, immediately close the water supply and repair the hose connections.

If your existing faucet adapter is not compatible with the "quick connect" hose assembly supplied, then the following procedures should be followed:

- Connect the faucet adapter (included with dishwasher) to your faucet.

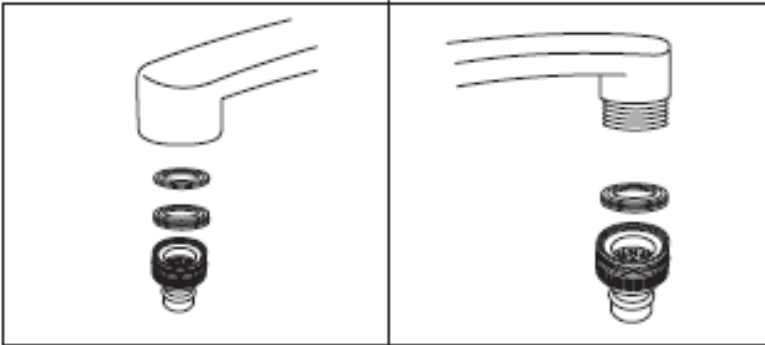

- If your faucet is inclusive of a 'female' type (threaded) connection, both rubber washers must be installed inside the faucet adapter.
- If your faucet is inclusive of a 'male' type (threaded) connection, use only the standard rubber washer (0.2"/5mm thick) supplied within the adapter. Remove the second rubber washer.